

Rigid Palletank® (1500L and above)

The 1500L, 2000L, 2500L Pallettanks® (fig 19) are available to order and are based on a non-stackable and non-foldable design. The bags are positioned using a nylon cable hanging system. The Flexel® 3D bag coupled with the rigid structure of the Pallettank® provide a stable and secure storage solution. Pallettanks® of this volume require a fork lift to move them around the processing area. A dolly is not available for these Pallettanks® :

1	Removable front panels	2	Front panel latches - secure locking of front panel
3	Stainless steel hanger - additional suspension based bag support	4	Nylon hanging cable
5	Limit stopper	6	Hexagonal bottom gates
7	Fixed gate section	8	Swinging gate section
9	Gate retaining clip	10	Gate retaining clip fastening point

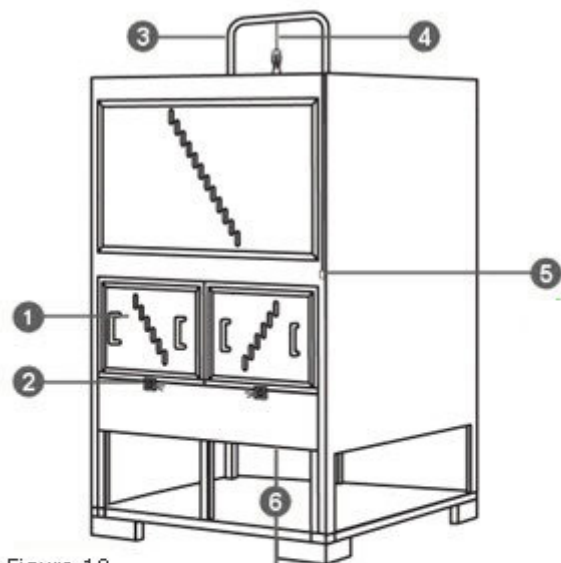

Figure 19

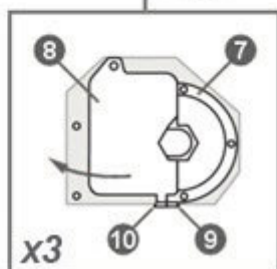

Figure 20