

142 mm Stainless Steel Holder for the Filtration of up to About 50 Liter Volumes



This holder is very often used in laboratories for particle removal and for sterile filtration of several liter volumes. It has a stable construction and is easy to operate. The large filtration area of 130 cm² ensures high flow rate for the total filter volume. The supplied unscrewable hose nipples can be replaced by G3/8 connectors, if systems with particularly practical handling is required.

The holder is designed for effective sterilization by autoclaving. The arrangement of the air venting valve in the top plate and the test valve in the base plate ensures the necessary vapour penetration. The back pressure screen has a smooth surface in order to avoid damages of the membrane filters, also when a glass fibre prefilter is used.

The swing-out locking clamps ensure a firm sealing with simple hand-tightening.



Specifications for the 142 mm holder with hose nipples

Chemical compatibility	As for stainless steel, PTFE, silicone and Viton. If required, the silicone O-rings can be replaced by EPDM O-rings (order no. 6982071), Viton O-rings (6982070) or PTFE O-rings (6982072, reduce the max. operating pressure to 4 bar, 58 psi), and the Viton valve O-rings by EPDM O-rings (6985184) or silicone O-rings (6985183).
Flow rate	For water at $\Delta p = 1$ bar (100 kPa, 14.5 psi), 2 l/min with 0.2 μm , 4,5 l/min with 0.45 μm , 11 l/min with 0.8 μm pore size.
Filtration area	130 cm ²
Weight	6 kg
Threads for connectors	M 12×1 female threads
Materials	Top part, base, corrugated iron, locking clamps, stainless steel legs and valve bodies 1.4401 (AISI 316). PTFE-coated stainless steel filter support and back pressure screen. Silicone O-rings (130×4 mm) in the top part and filter support. Viton valve O-rings (3×1.5 mm). PTFE flat gasket on valves.
Max. operating pressure	7 bar (700 kPa, 101.5 psi)
Suitable membrane filter diameter	142 mm (prefilter, 130 mm)
Sterilization	By autoclaving (max 134°C) or by dry heat (180°C).

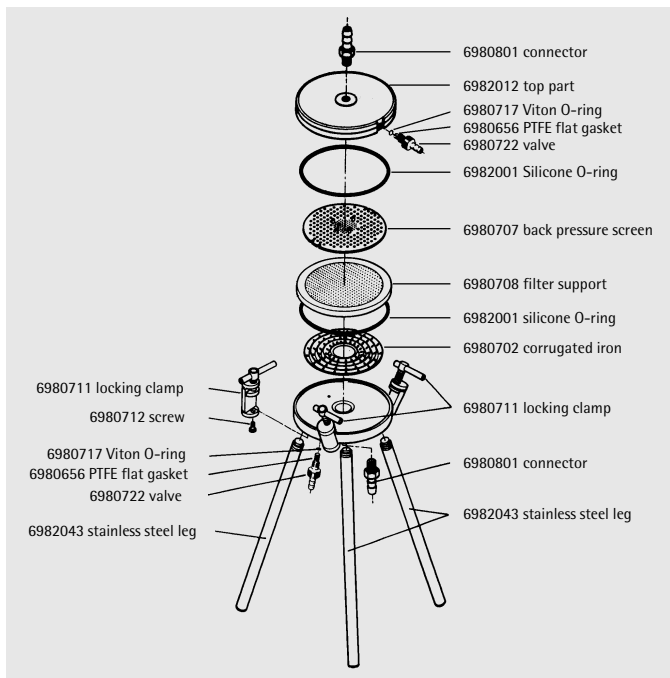

Order number for the 142 mm holder with hose nipples

16275	142 mm in-line stainless steel filter holder
16660	Laboratory tripod with special socket (100 cm, ca. 33 mm \varnothing)

Recommended accessories are described on page 72. Replacement parts are shown in the diagram.