

## 47 mm Stainless Steel Filter Holder for In-line Filtration

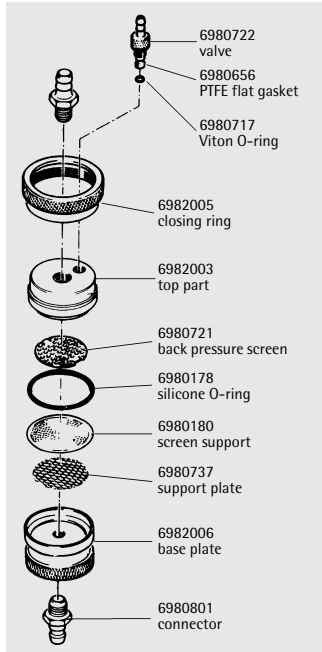

### The 47 mm filter holder

Tolerates pressure of up to 20 bar. The inlet side valve is convenient for the intermittent run-off of waste water. Other connectors, available as accessories, fit the holder onto reducing valves or pumps with G3/8 female thread (order no. 17089), or onto pressure tanks with G3/8 male thread (17069) or on taps with G3/4 male thread (17068).



### Specifications

Connectors	Hose nipples DN10
Connection thread	M12×1
Filtration area	13 cm <sup>2</sup>
Flow rate	For air at $\Delta p = 0.3$ bar (4.35 psi): 0.5 l/min with 0.2 $\mu\text{m}$ , 1.0 l/min with 0.45 $\mu\text{m}$ pore size
Weight	ca. 490 g
Materials	Stainless steel, except silicone O-ring (42 × 3 mm), PTFE and Viton valve seals
Max. operating pressure	20 bar (2,000 kPa, 290 psi)
Suitable membrane filter	47 mm, type 118
Sterilization	By autoclaving (max. 134°C) or by dry heat (max. 180°C).

### Order number

16254	Stainless steel holder for 47 mm $\varnothing$ membrane filter.
-------	---

Replacement parts are shown in the diagram.